

# HERITAGE

## BATHROOMS

### *Installation Guide*



Models Covered:

**Undercounter Basin**

Please keep this booklet for future reference.

Installer: When you have read these instructions, please ensure you leave them with the user.

---

# INTRODUCTION

---

Thank you for buying a Heritage Product. When you buy a Heritage product, you can be confident that it not only features a beautiful, distinctive, classic design, but that it has also been made to the very highest quality standards.

To ensure that it works to its full potential, it needs to be fitted correctly.

These fitting instructions have been created to give you all of the information you need and, if you need any further help, please do not hesitate to give us a call on: 0330 026 8503.

---

## CONTENTS

---

SAFETY NOTES	3
INSTALLER GUIDELINES	3
TOOLS REQUIRED	3
INSTALLATION	4-5
NOTES	6
CARING FOR YOUR PRODUCT	7
GUARANTEE	7
NEED HELP?	7



---

## SAFETY NOTES

---

Please make sure you read these instructions and retain for future use.

All products manufactured by Heritage Bathrooms are safe, providing they are installed and used correctly and also receive maintenance when needed.

Basins, including the connecting water and waste system need to be installed in accordance with and meet the requirements of the Water Supply Regulations 1999 (Water Fittings) and current by-laws. If you are in doubt about your ability to install this product correctly or safely, you should employ the services of an experienced qualified plumber.

This product must not be modified in any way otherwise this will invalidate the guarantee.

Consider the following whilst using power tools:

- Prior to drilling into walls, check there are no hidden electrical cables or wires and there are also no water pipes. These can potentially be found using an electrical or metal detector.
- Wear the correct PPE, especially ear, eye and hand protection when using power tools. Unplug any mains equipment after use.
- Keep electrical equipment away from sources of water.

UK  
CA

CE

---

## INSTALLER GUIDELINES

---

Please note worktops, taps and wastes are supplied separately. Please follow those fitting instructions for information on how to prepare for installation.



Place your worktop on a soft surface to prevent scratches and damage.

---

## TOOLS REQUIRED

---

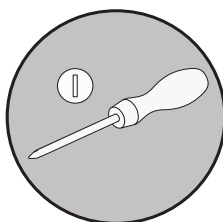

**Flat Head Screwdriver**

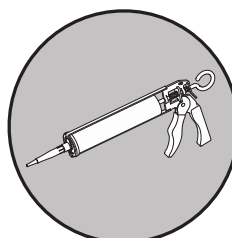

**Silicone Sealant**



# INSTALLATION

## FITTING YOUR BASIN TO YOUR WORKTOP

If tap holes are required, please follow your worktop instructions for more information and installation steps.

Once tapholes have been cut or if they are not required, please follow steps below to complete the installation of your basin.

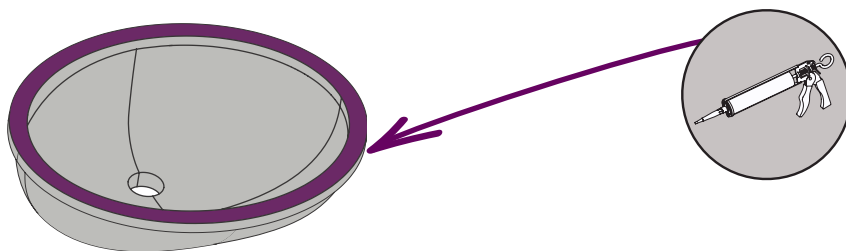

Apply silicone sealant to the rim of the basin

Insert the threaded screw through the wingnut, metal washer and bracket.

Position the basin onto the chosen worktop. Align basin in place so that there is an even overhang on all edges. (View from the top). The basin overflow should be at the back of the basin/worktop. Using a screwdriver, tighten the threaded screw into one of the pre-drilled holes in the worktop.

 DO NOT OVERTIGHTEN



Tighten the wingnuts by hand.



Overtightening your fittings can cause damage to your sanitaryware and your worktop

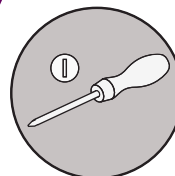
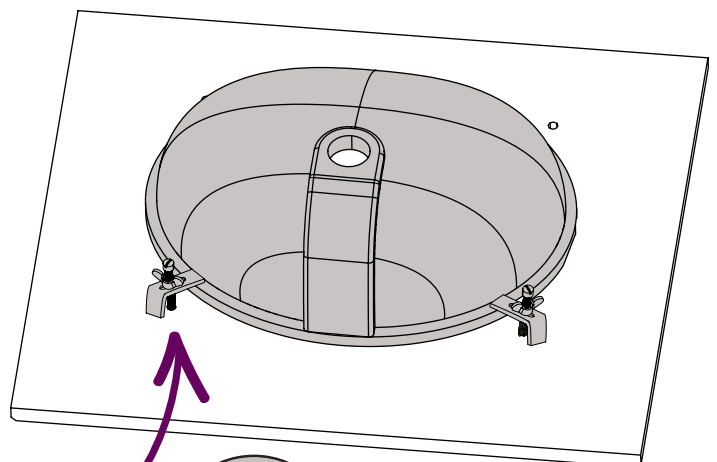
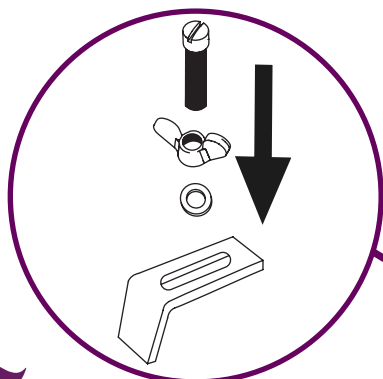

# INSTALLATION

## SECURING THE WORKTOP

Apply silicone sealant along the vanity unit before placing the worktop, secure and wipe off any excess.

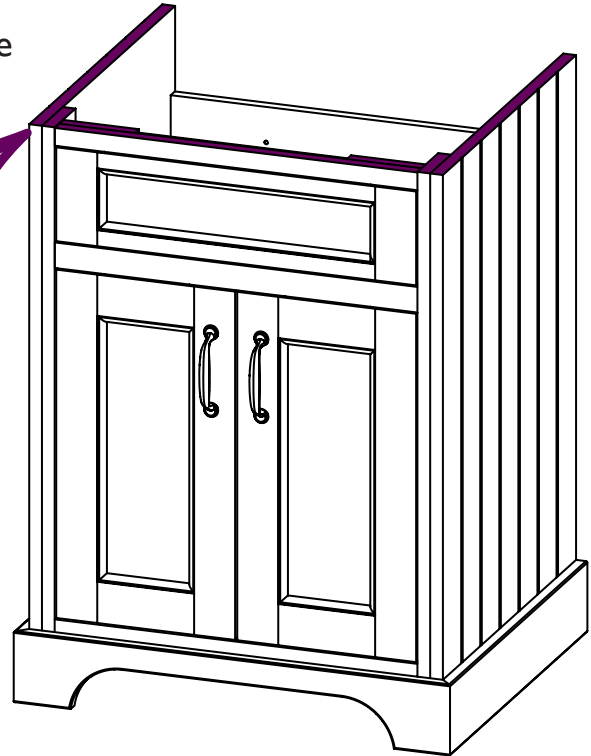
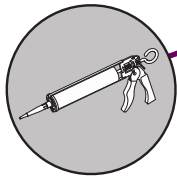

## GOOD TO KNOW

Access to waste connections via the main doors of the vanity unit.

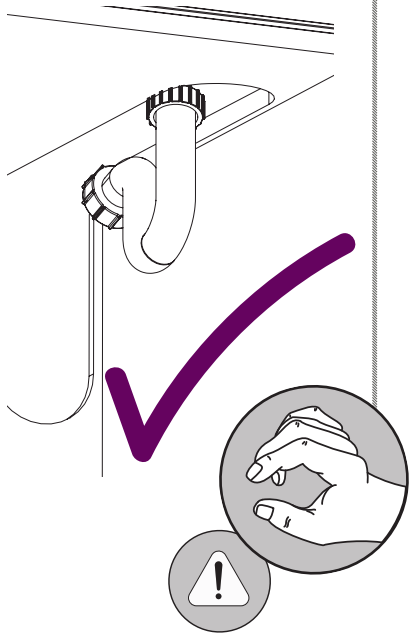

Over tightening fittings, especially wastes can cause pressure cracks in your sanitaryware.

Wipe any excess silicone sealant and smooth around the rim of basin.

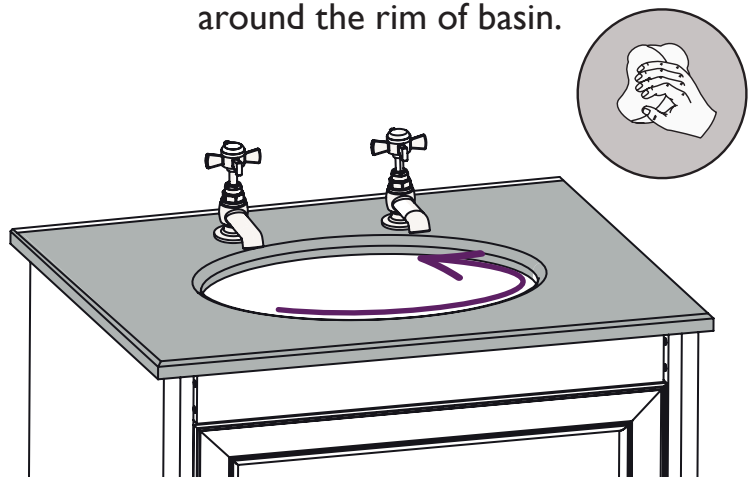

---

# NOTES

---



---

## CARING FOR YOUR PRODUCT

---

Your fitting has a high quality finish and should be treated with care to preserve the surface.

- All surface finishes will wear if not cleaned correctly.
  - The only safe way to clean your product is to wipe with a soft damp cloth. Any stains can be removed using washing up liquid.
  - Do not use cleaning powders or liquids.
  - Even non-scratch cleaners may damage the surface of your fitting.
  - Avoid liquids that are likely to stain, if liquids are spilt they should be cleaned immediately.
- 

## GUARANTEE

---

The confidence we have in the quality of our products and services enables us to offer a free peace-of-mind product guarantee from 2 years up to a lifetime guarantee against any manufacturing faults, with proof of purchase. In addition, our attentive customer service team are available to help solve any problems which may arise quickly and effectively so you can enjoy your bathroom.

To see the specific guarantee for this product, scan the QR Code or visit the following URL:

<https://www.heritagebathrooms.com/service-centre/guarantee>

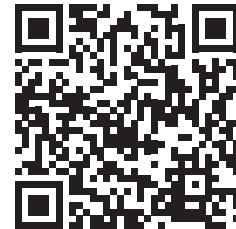

---

## NEED HELP?

---

If your product does not function correctly when you first use it, contact your plumber and make sure that it has been installed and commissioned in line with this Installation and User Guide supplied with the product. If this doesn't solve the problem, then please visit <https://www.heritagebathrooms.com/service-centre/help-and-advice> for some helpful hints and tips; or contact Heritage Customer Service on 0330 026 8503 where our expert team of advisors will be able to offer you, or your plumber, help and advice.



# HERITAGE<sup>®</sup>

## BATHROOMS

We love to see how Heritage products are used so please keep in touch and share pictures of your new bathroom with us.



@heritagebathrooms

If you have any queries, our dedicated customer service teams and products experts are available to help.

Email us [enquire@heritagebathrooms.com](mailto:enquire@heritagebathrooms.com) Call us **0330 026 8503** Website [www.heritagebathrooms.com](http://www.heritagebathrooms.com)

UK: Heritage Bathrooms, Pooley Hall Drive, Birch Coppice Business Park, Dordon, Tamworth B78 1SG

EU: Masco Europe S.à.r.l., 14 Rue Strachen, 6933 Mensdorf, Luxembourg.